

LIXEIRA M - 54L

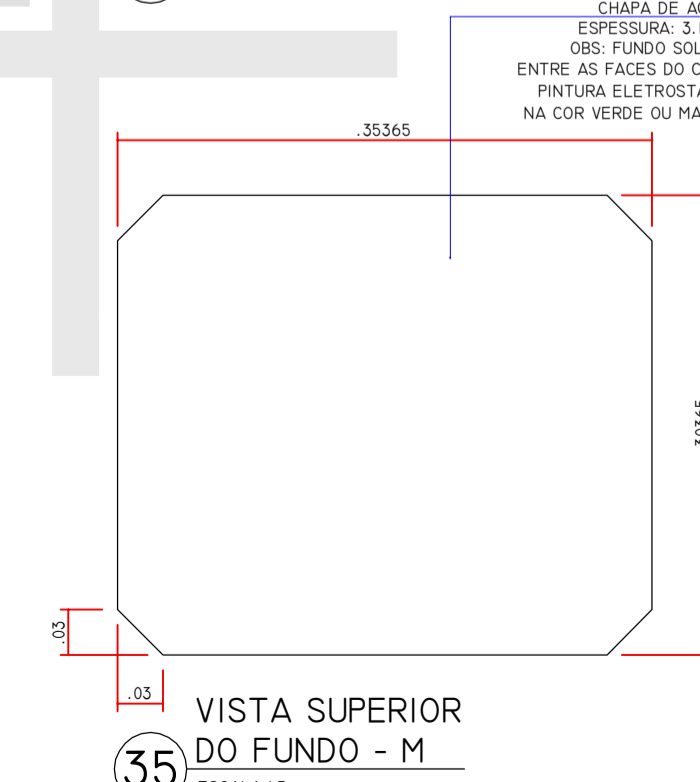
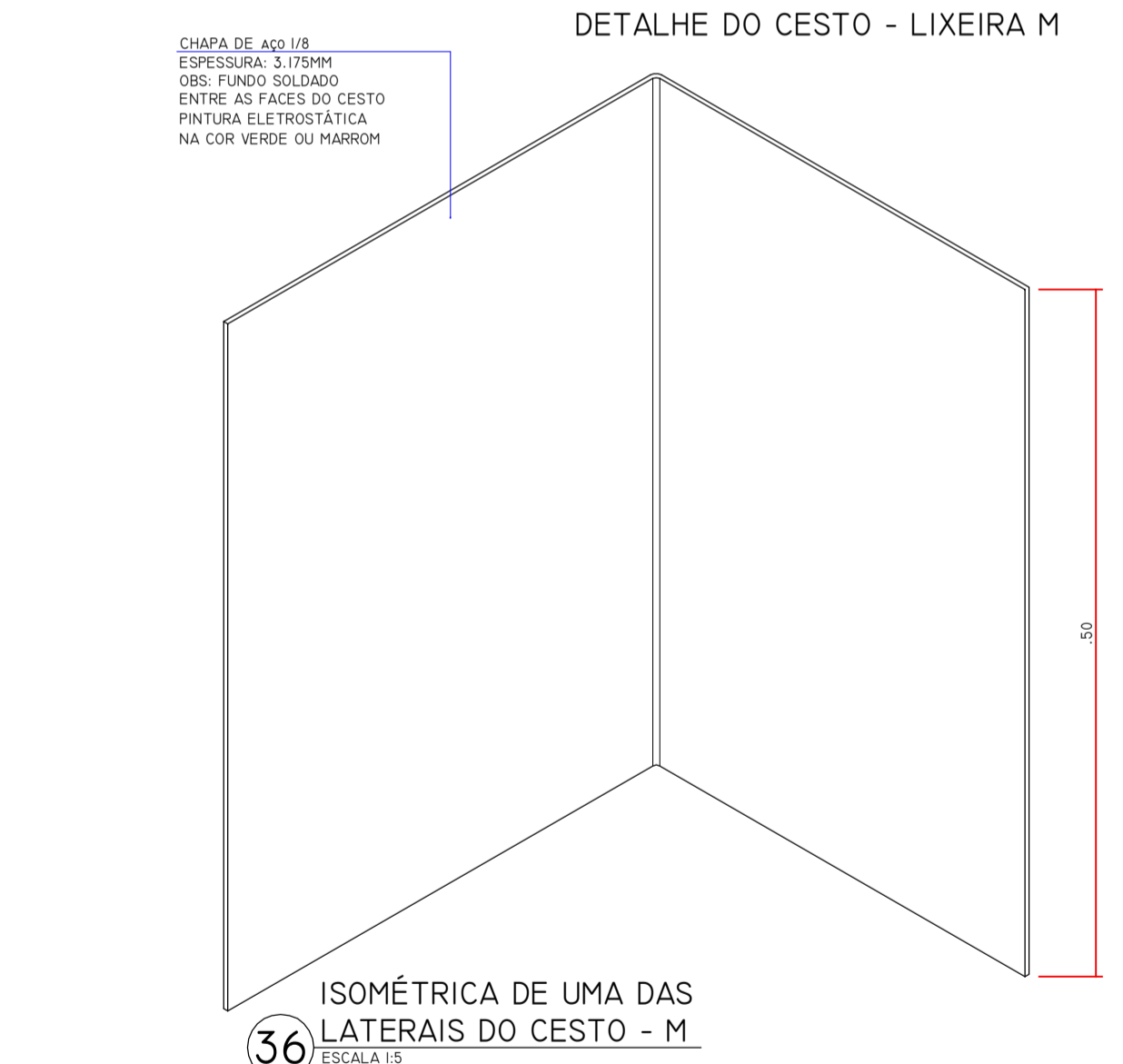
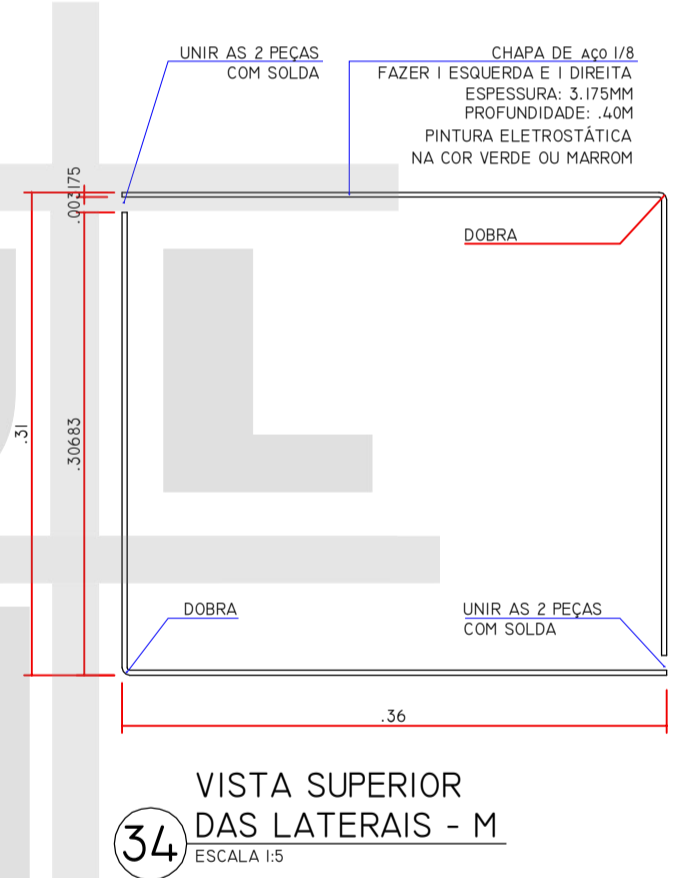
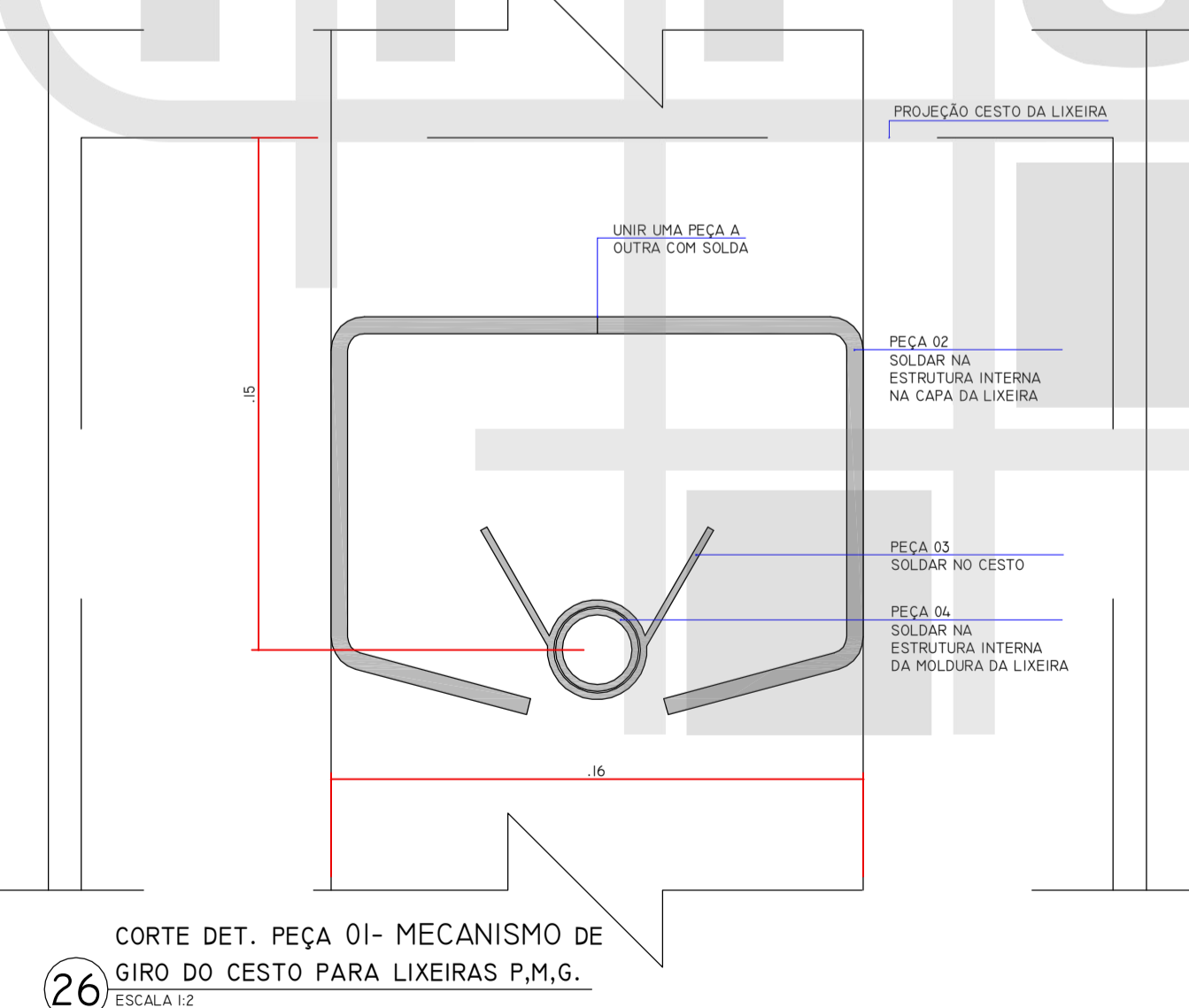
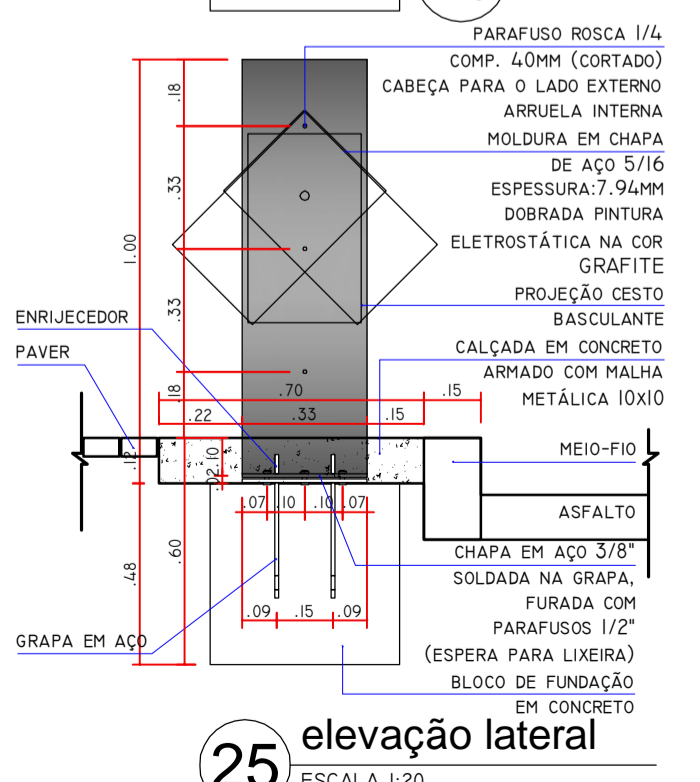
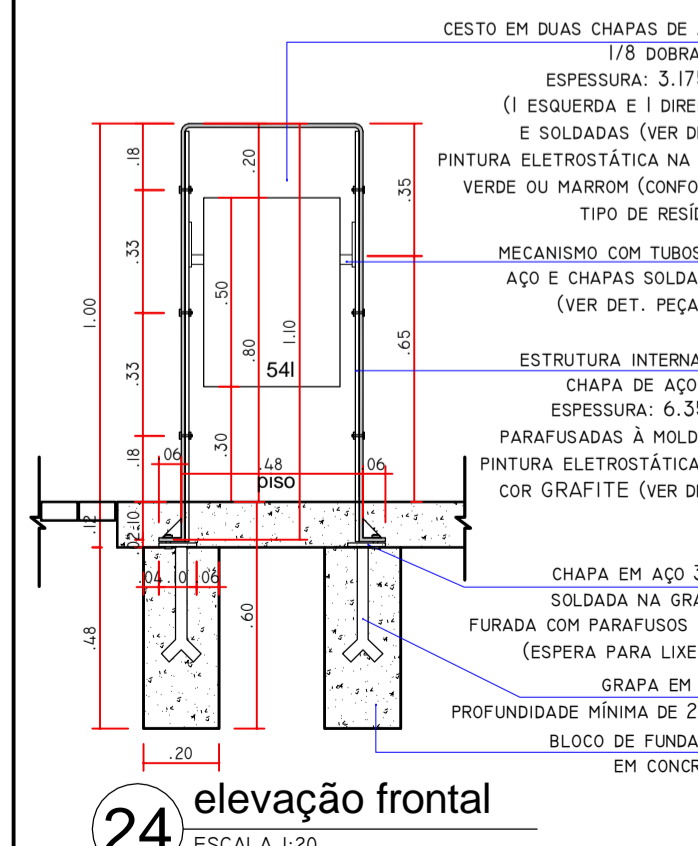
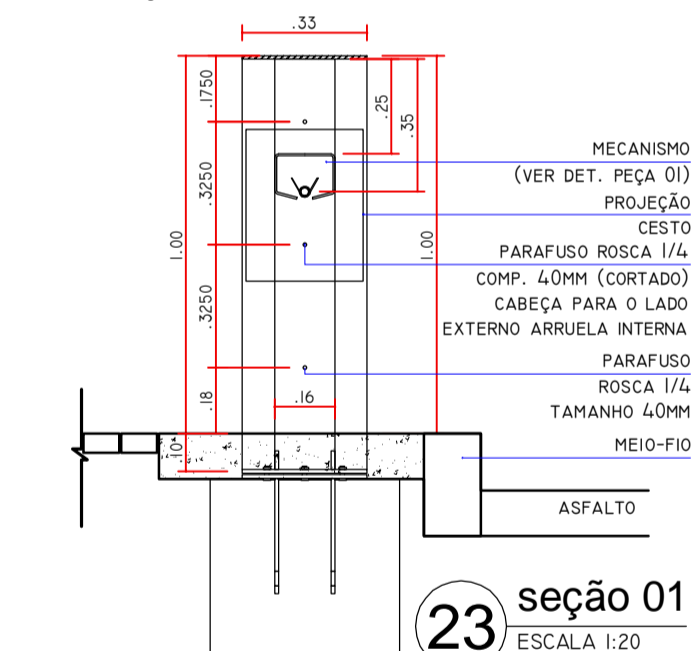
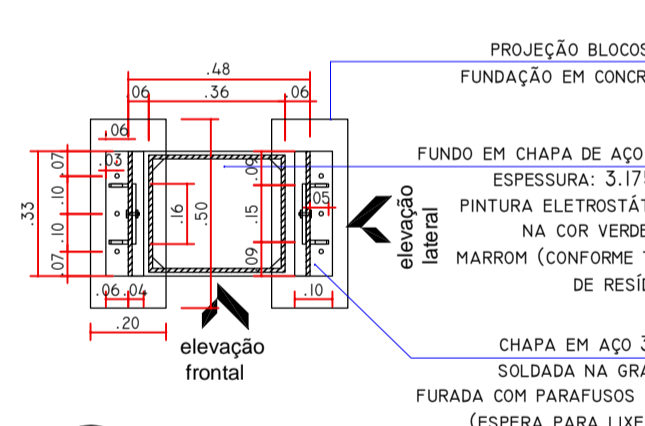
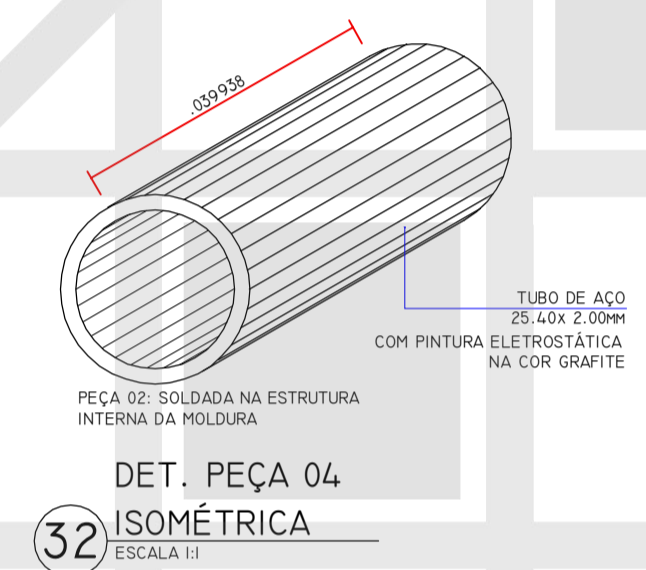
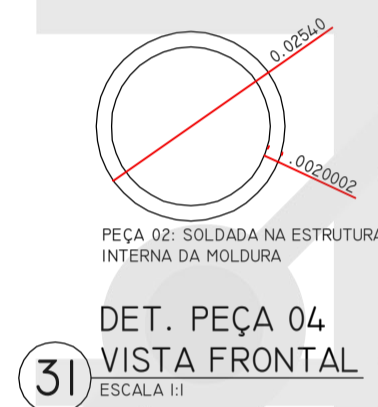
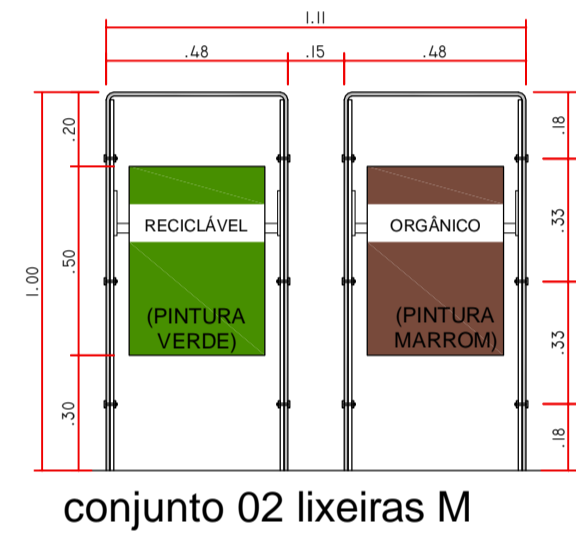
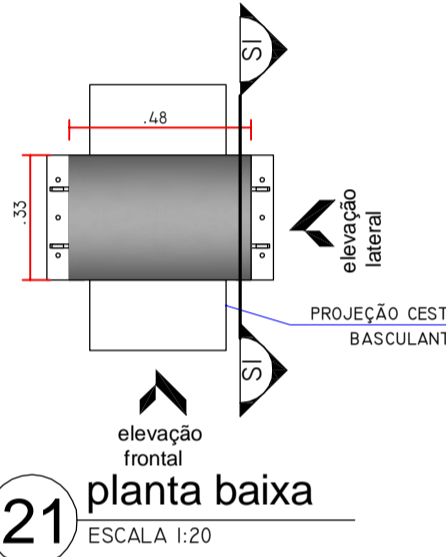

INSTITUTO DE PESQUISA E PLANEJAMENTO URBANO DE LONDRINA DIRETORIA DE PROJETOS			
AV. DUQUE DE CAXIAS, 635 - 2º ANDAR CEP 86015-901 JD. MAZZEI-LONDRINA-PARANÁ TEL. (043) 3372-4723 FAX. (043) 3372-4714			
DIRETOR PRESIDENTE IGNES DEQUECH ALVARES	GERENTE DE PROJETOS URBANÍSTICOS E EDIFICAÇÕES SIMONE DE OLIVEIRA FERNANDES VECCHIATTI	ARQUIVO I4.06	
DIRETOR DE PROJETOS HUMBERTO CARNEIRO LEAL	GERENTE DE LEVANTAMENTO EM CAMPO E APOIO CLAUDIA STELLA MONTEIRO RODRIGUES DE PADUA	Nº REQUERIMENTO PEDIDO VERBAL	
ARQUITETA E URBANISTA AMANDA M. SALVINI E ANA F. GALINARI		ESTAGIÁRIO (A) MAYARA CARMO	
PROJETO PONTO DE ÔNIBUS NA WARTA	PRANCHA Nº: 04/04	ESCALAS: INDICADA	DATA: 10/03/2015
TÍTULO DETALHE DE LIXEIRA (OPCIONAL)	LOCAL DA OBRA: LONDRINA - PR		
PROPRIETÁRIO: PREFEITURA DO MUNICÍPIO DE LONDRINA	CPF / CNPJ: 75-771-477/0001-70	INSCRIÇÃO NO IPTU: ---	